

S01 - Scala 1:50

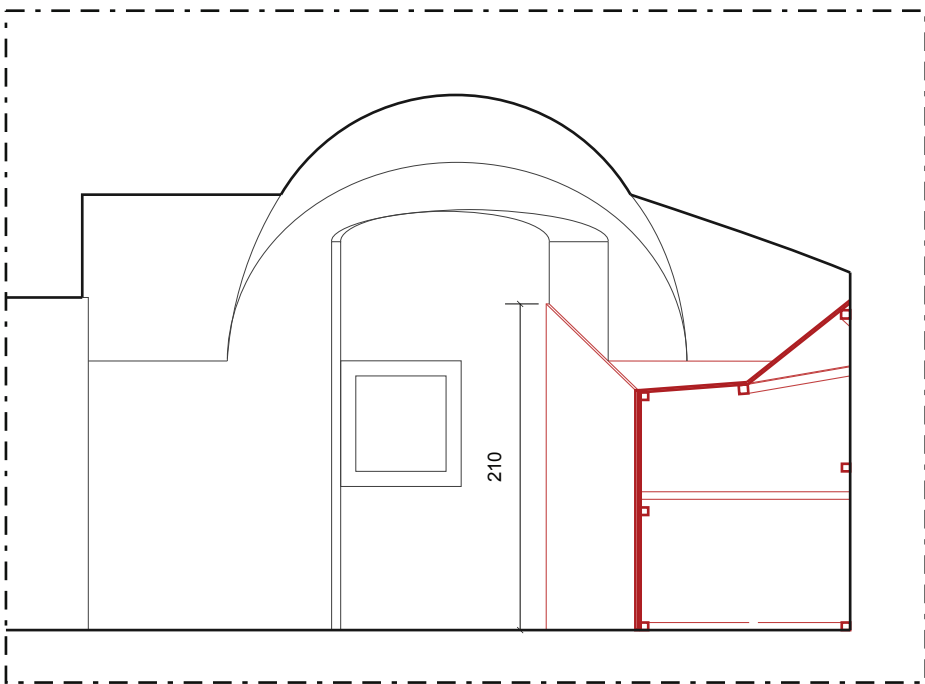

S02 - Scala 1:50

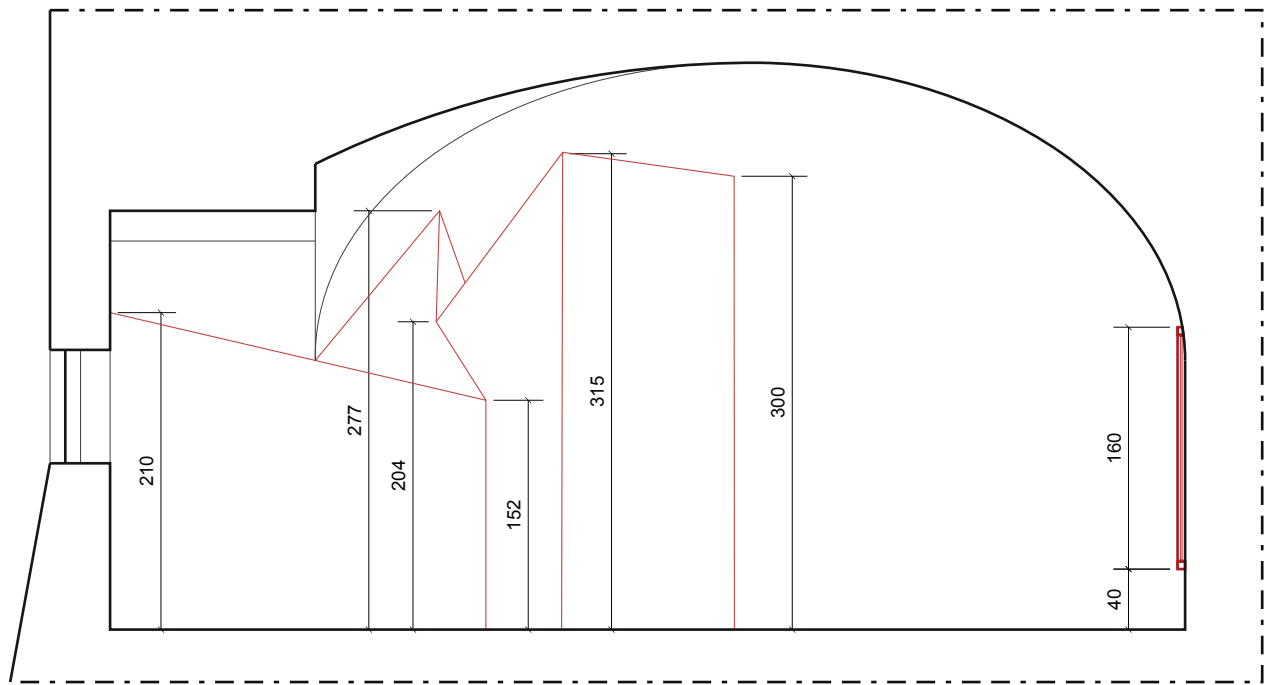

S03 - Scala 1:50

telaio strutturale in tubolari di
acciaio 40 x 40 x 2mm.

pannello in mdf ignifugo
spessore 10 mm.

pannello in dibond 3 mm
stampato in quadricromia

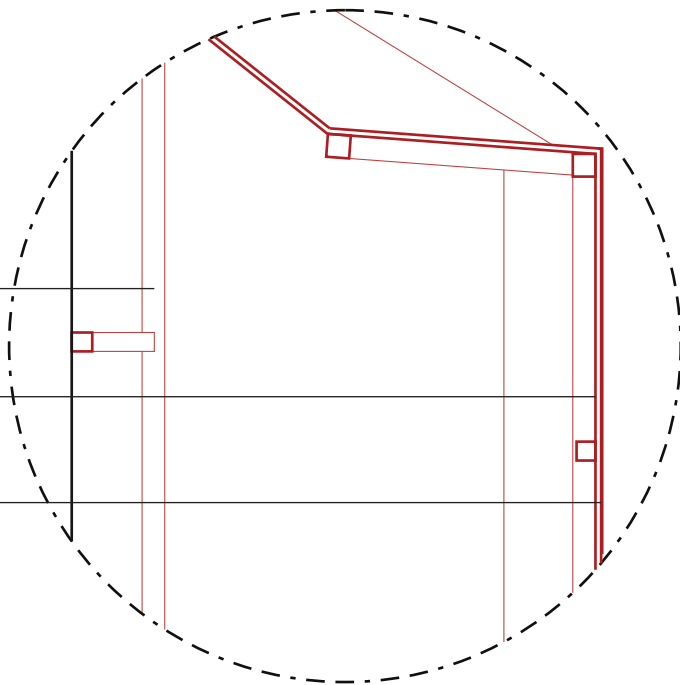

Totem statico - Particolare Scala 1:20

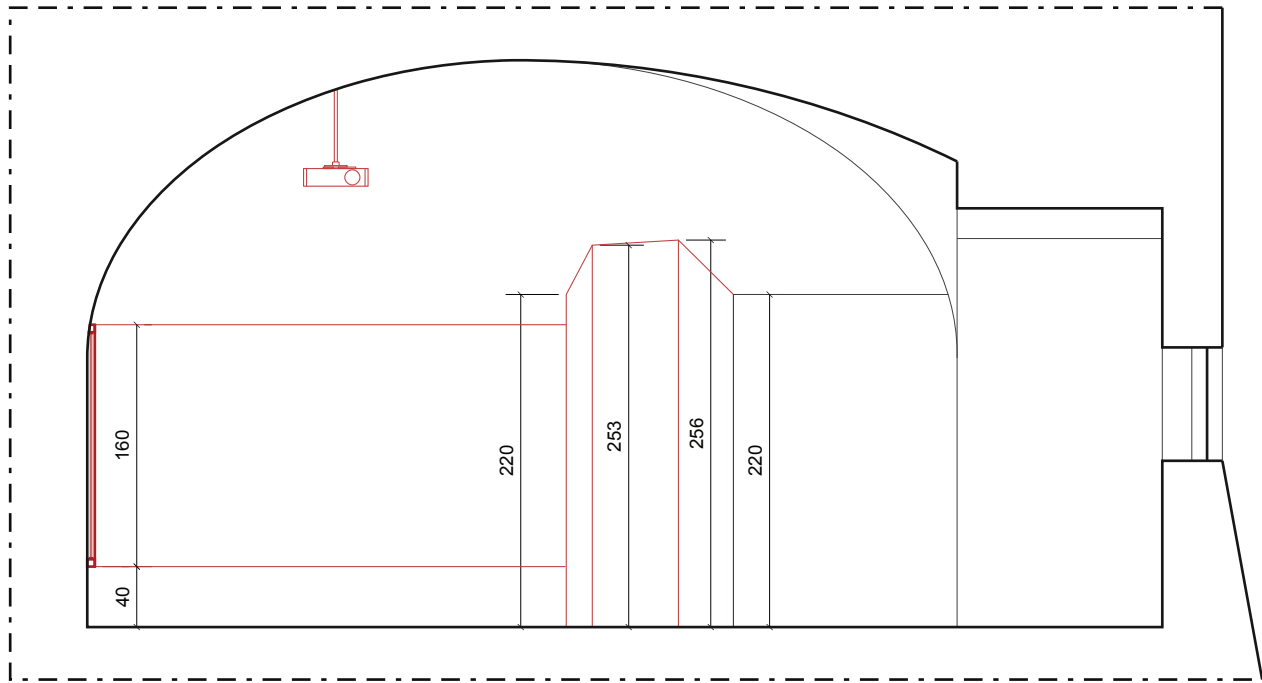

S04 - Scala 1:50

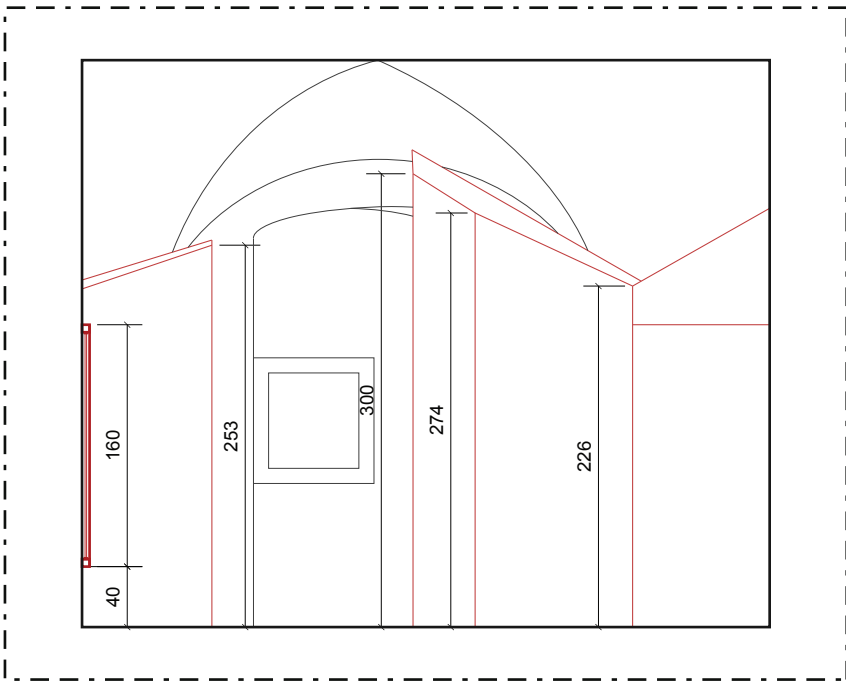

S05 - Scala 1:50

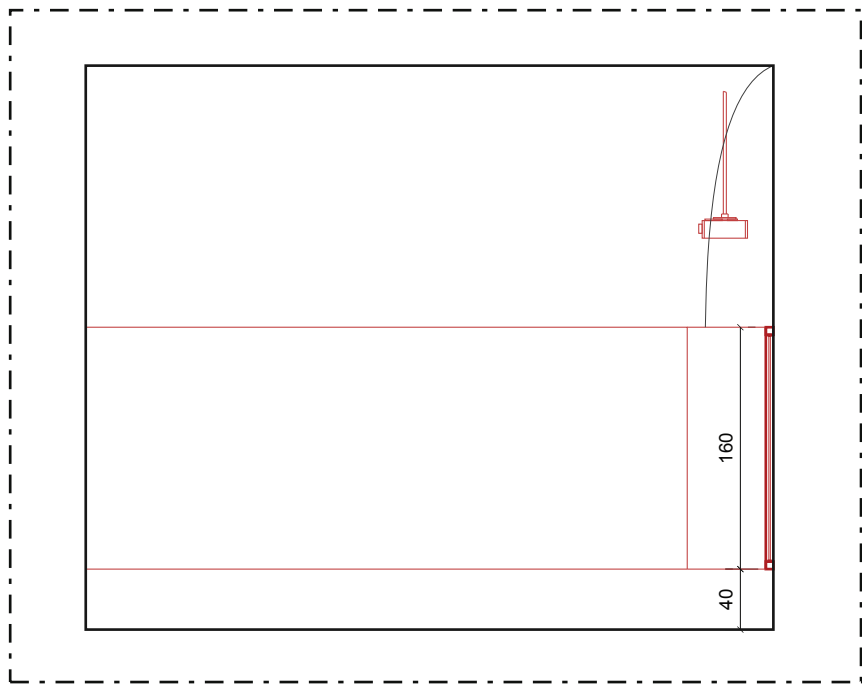

S06 - Scala 1:50

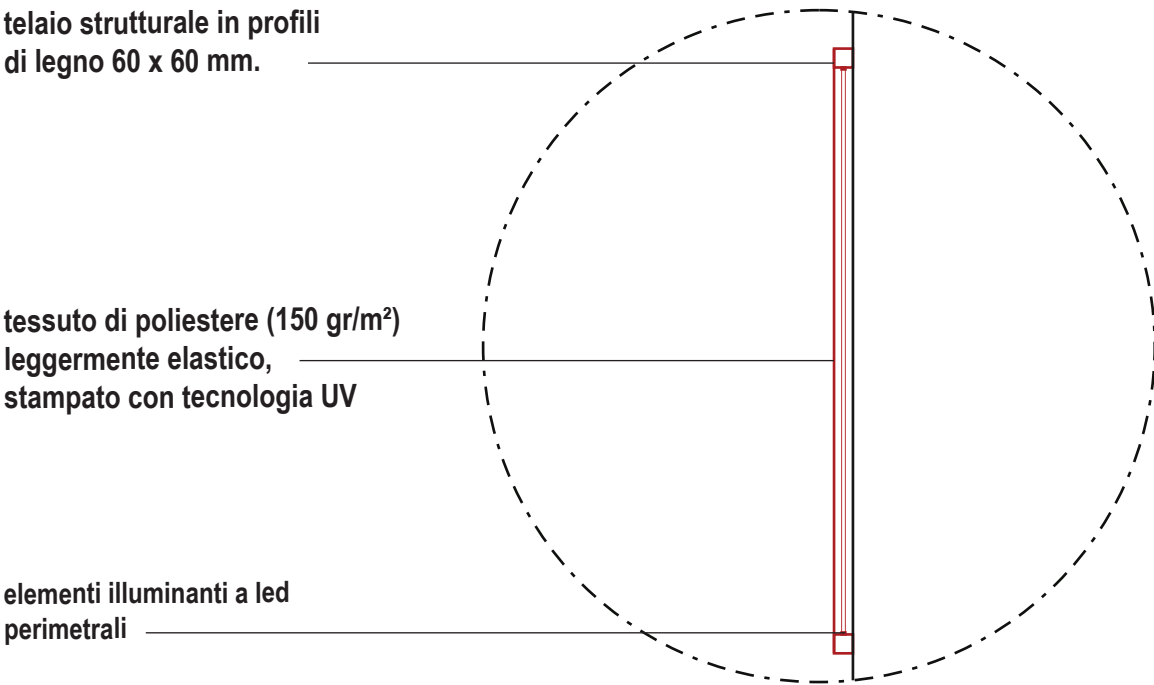

Pannello grafico retroilluminato - Particolare Scala 1:20